

iQ500, Built-in oven with added steam function, Width 60 cm HR578G5S6B



Shorten your cooking time thanks to fast preheat, coolStart and activeClean. And remote control your oven from anywhere with Home Connect.

- ✓ fast preheat: reach the required baking temperature sooner; coolStart: no need to preheat the oven for deep frozen food.
- ✓ activeClean: the automatic system for effortless cleaning.
- ✓ The addedSteam function: for crispy crusts and juicy roasts.
- ✓ Home Connect: Allows access and control your oven, no matter where you are - with the easy-to-use Home Connect App
- ✓ roastingSensor: simply reliable roasting.

Features

Technical Data

Color / Material Front : Stainless steel
Construction type : Built-in
Integrated Cleaning system : Pyrolytic
Required niche size for installation (HxWxD) : 585-595 x 560-568 x 550
Dimensions : 595 x 594 x 548
Dimensions of the packed product (HxWxD) (mm) : 660 x 690 x 660
Control Panel Material : Glass
Door Material : Glass
Net weight (kg) : 39.828
Usable volume of cavity (l) : 71
Cooking method : Conventional heat, Full width grill, Hot Air, Hotair gentle, Hot air grilling, Pizza setting
First cavity material : Other
Temperature control : electronic
Number of interior lights : 1
Approval certificates : CE, VDE
Length of electrical supply cord (cm) : 120
EAN code : 4242003856178
Number of cavities (2010/30/EC) : 1
Energy efficiency rating : A
Energy consumption per cycle conventional (2010/30/EC) : 0.99
Energy consumption per cycle forced air convection (2010/30/EC) : 0.81
Energy efficiency index (2010/30/EC) : 95.3
Connection rating (W) : 3600
Current (A) : 16
Voltage (V) : 220-240
Frequency (Hz) : 50; 60
Plug type : no plug

Optional accessories

HZ915003	Glass roasting dish, 5,4 L
HZ66X650	Cover Strip
HZ638300	3 level telescopic rails, full ext
HZ636000	Glass pan
HZ634000	Baking and roasting grid (standard)
HZ625071	Grill tray, anthracite enamelled
HZ538000	varioClip rail
HZ531010	Baking tray, non-stick ceramic coated
HZ531000	Baking tray, grey enamelled
HZ327000	Baking stone



iQ500, Built-in oven with added steam function, Width 60 cm HR578G5S6B

Features

Design

- LCD Display (White)
- lightControl: intuitive operation thanks to the illuminated dials
- Enamel grey
- Drop down oven door, softClose, softOpen
- lightControl: intuitive operation thanks to the illuminated dials, round
- Bar handle
- We recommend you to choose complementary products within iQ500, in order to assure an optimal design combination of your Built-In appliances.

Features

- Digital temperature display with proposal Heating-up indicator
- Sabbath setting cookControl Automatic start
- Electronic door lock Control panel lock Automatic safety switch off
- Residual heat indicator Door contact switch
- WLAN - Home connect enabled
- Automatic programmes
- cookControl, 30
- roastingSensor
- Electronic oven clock timer
- Integral cooling fan
- Interior halogen light
- 5 shelf positions in oven

Cleaning

- activeClean
- Full glass inner door

Programmes/functions

- Oven with 8 heating methods: 3D hot air, conventional top & bottom heating, hot air grilling, full width grill, Pizza setting, coolStart, Hotair gentle, reheating
- Heating modes in combination with steam function: Hot air, Hot air grilling, Top/bottom heat
- Additional functions: Descaling programme
- Fast preheat

Accessories

- 2 x combination grid, 1 x universal pan
- 1 varioClip rail, Stop function

Technical information

- Energy efficiency rating (acc. EU Nr. 65/2014): A Energy consumption per cycle in conventional mode: 0.99 kWh Energy consumption per cycle in fan-forced convection mode: 0.81 kWh Number of cavities: Main cavity Heat source: electrical Cavity volume: 71 litres
- Water tank capacity: with a volume of 220ml
- Temperature range 30 °C - 275 °C
- Location of water tank: Outside cavity
- Total connected load electric: 3.6 KW
- 120 cm Cable length
- Nominal voltage: 220 - 240 V
- Appliance dimension (h x w x d): 595 mm x 594 mm x 548 mm
- Niche dimension (h x w x d): 585 mm - 595 mm x 560 mm - 568 mm x 550 mm
- Please refer to the dimensions provided in the installation manual

iQ500, Built-in oven with added steam function, Width 60 cm HR578G5S6B

Dimensioned drawings

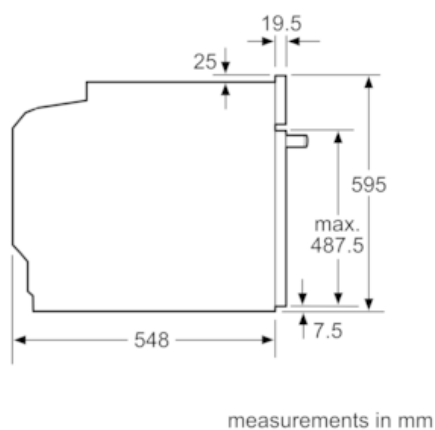
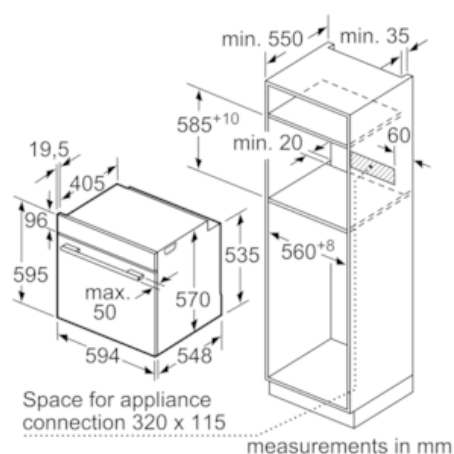
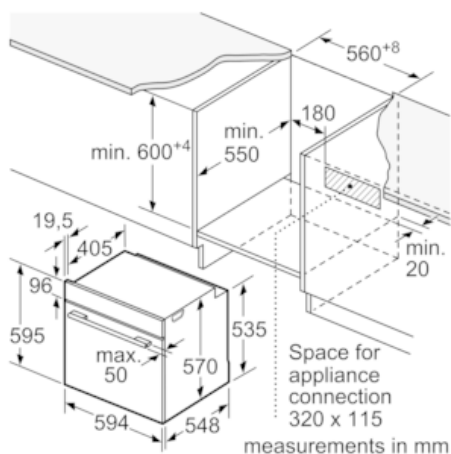

Installation with a hob.

