

Serie | 8, Washing machine, front loader, 9 kg, 1400 rpm
WAV28MH4GB



Optional accessories

WMZ2200 :
WMZ2381 :

The Serie|8 washer with Home Connect, with 4 AntiStain programmes and 4D Wash System with Intensive Plus provides spotless results with every load fully automatic.

- **AutoStain:** removes the four most common stains.
- **4D Wash System:** highly efficient water and detergent fabric penetration for spotless results.
- **Home Connect:** home appliances with smart connectivity for an easier everyday life.
- **EcoSilence Drive™:** extremely energy-efficient and quiet in operation with a 10-year warranty.
- **AllergyPlus:** specially developed for the needs of allergy sufferers and sensitive skin.

Technical Data

Energy Efficiency Class (Regulation (EU) 2017/1369):	A
Weighted energy consumption in kWh per 100 washing cycles of eco 40-60 programme (EU 2017/1369):	48
Maximum capacity in kg (EU 2017/1369):	9.0
The water consumption of the eco programme in liters per cycle (EU 2017/1369):	48
Duration of eco 40-60 programme in hours and mins at rated capacity (EU 2017/1369):	3:44
Spin-drying efficiency class of eco 40-60 programme (EU 2017/1369):	B
Airborne acoustical noise emission class (EU 2017/1369):	A
Airborne acoustical noise emissions (EU 2017/1369):	69
Construction type:	Free-standing
Height of removable worktop (mm):	850
Dimensions of the product (mm):	848 x 598 x 590
Net weight (kg):	72.303
Connection rating (W):	2300
Current (A):	10
Voltage (V):	220-240
Frequency (Hz):	50
Approval certificates:	CE, VDE
Length of electrical supply cord (cm):	210
Door hinge:	Left
Wheels:	No
EAN code:	4242005285952
Installation type:	Free-standing



Serie | 8, Washing machine, front loader, 9 kg, 1400 rpm WAV28MH4GB

The Serie|8 washer with Home Connect, with 4 AntiStain programmes and 4D Wash System with Intensive Plus provides spotless results with every load fully automatic.

Performance

- Energy Efficiency Class¹: A
- Energy² / Water³: 48 kWh / 48 litres
- Load capacity: 1 - 9 kg
- Programme duration⁴: 3:44 h:min
- Spin drying efficiency class: B
- Spin speed^{**}: 400 - 1400 rpm
- Noise level: 69 dB (A) re 1 pW
- Noise efficiency class: A

Programmes/functions

- Standard programmes: cottons, easy care, delicates, wool hand wash
- Special programmes: Allergy +, Drum clean with reminder, Shirts, jeans/dark laundry, Drain / Spin, Mixed Load, Sportswear, Single Rinse, Super Quick 15/30

Key features

- Home Connect: Remote Monitoring and Control, iService Remote, Energy Management Photovoltaic
- AutoStain Removal System with 4 stain options - actioned with standard programmes
- Touch control buttons: On/off, Ready in, stain selection, Intensive Plus, Rinse Plus, Remote Start, start/pause with reload function, Temperature selection, SpeedPerfect, Prewash, Spin speed reduction/Rinse Hold

Additional features

- Reload function: Be flexible in adding laundry items even after start of the wash cycle.
- Large LCD display for programme status indication, temperature selection, max. spin speed, remaining time and

24 hours end time delay, stain selection and consumption indication

- 4D Wash System: highly efficient water and detergent fabric penetration for spotless results.
- Drum volume: 65 litres
- Drum interior light
- VarioDrum: gentle and efficient washing
- Drum clean with reminder function
- Large chrome, white door with 171° opening
- Reload function: Flexibility in adding laundry items into the drum, even after the wash cycle has started.
- EcoSilence drive with 10 year warranty
- EcoSilence drive with 10 year warranty
- ActiveWater Plus: for highly efficient use of water even with small loads thanks to automatic load detection.
- Consump indicator energy+water, AutoStain Removal System
- AntiVibration Design - for more stability and quietness
- Sound insulation by additional noise reduction material
- Sound insulation by additional noise reduction material
- Multiple Water Protection
- EcoBar Plus function: five possible levels of energy and water consumption
- Control dial with integrated On / Off mode
- Foam detection system
- Overdosage indication
- Safeguard monitoring system adjusts load distribution and programme settings to protect clothes
- Child lock
- Acoustic signals: Buzzer
- Detergent dispensing: easy clean
- Divider for Liquid Detergent

Technical Information

- Slide-under installation
- Dimensions (H x W): 84.8 cm x 59.8 cm
- Appliance depth: 59.0 cm
- Appliance depth incl. door: 63.2 cm
- Appliance depth with open door: 106.3 cm

¹ Scale of Energy Efficiency Classes from A to G

² Energy consumption in kWh per 100 cycles (in programme Eco 40-60)

³ Weighted water consumption in litres per cycle (in programme Eco 40-60)

⁴ Duration of Eco 40-60 programme

^{**} Values are rounded.

**Serie | 8, Washing machine, front loader, 9
kg, 1400 rpm
WAV28MH4GB**

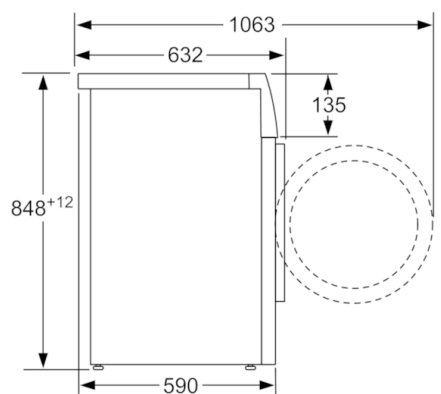

measurements in mm

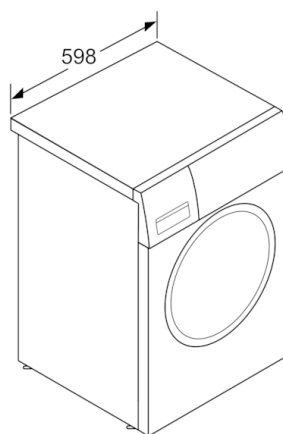

measurements in mm