

**Serie | 6, Built-in oven, 60 x 60 cm,  
Black  
HBG539BB6B**



**A**



**Included accessories**

2 x combination grid  
1 x universal pan

**Optional accessories**

HEZ531010 : Baking tray, non-stick ceramic coated  
HEZ538000 : 1fold telescopic rail, level independent  
HEZ634000 : Baking and roasting grid (standard)  
HEZ636000 : Glass pan  
HEZ915003 : Glass roasting dish, 5,4 L

**The built-in oven with AutoPilot:  
automatically prepares perfect dishes.**

- **3D Hotair:** even heat distribution for perfect results on up to three levels.
- **AutoPilot 40:** every dish is a perfect success thanks to 40 pre-set automatic programmes.
- **Pop-out controls:** Make the front of the oven easy to clean and give it a sleek look.
- **EcoClean Direct:** less cleaning effort thanks to a special coating of the rear wall that automatically absorbs grime.
- **Cleaning Assistance:** less cleaning effort thanks to the new cleaning option, which can be especially used for cleaning of light soiling.

**Technical Data**

Color / Material Front : Black  
Construction type : Built-in  
Integrated Cleaning system : Catalytic partial, Hydrolytic  
Min. required niche size for installation (HxWxD) : 585-595 x 560-568 x 550 mm  
Dimensions : 595 x 594 x 548 mm  
Dimensions of the packed product (HxWxD) : 675 x 690 x 660 mm  
Control Panel Material : Glass  
Door Material : Glass  
Net weight : 36.7 kg  
Usable volume of cavity : 71 l  
First cavity material : Other  
Oven control : electronic  
Number of interior lights : 1  
Length of electrical supply cord : 120 cm  
EAN code : 4242005343744  
Number of cavities (2010/30/EC) : 1  
Energy efficiency rating : A  
Energy consumption per cycle conventional (2010/30/EC) : 0.97 kWh/cycle  
Energy consumption per cycle forced air convection (2010/30/EC) : 0.81 kWh/cycle  
Energy efficiency index (2010/30/EC) : 95.3 %  
Connection rating : 2990 W  
Fuse protection : 13 A  
Voltage : 220-240 V  
Frequency : 50; 60 Hz  
Plug type : no plug (electrical connection by electrician)  
Included accessories : 2 x combination grid, 1 x universal pan



## Serie | 6, Built-in oven, 60 x 60 cm, Black HBG539BB6B

**The built-in oven with AutoPilot:  
automatically prepares perfect dishes.**

### Features

- Oven with 13 cooking functions: heating methods: 3D Hotair, conventional top and bottom heat, Hotair grilling, full width variable grill, half width grill, pizza function, bottom heat, intensive heat, low temperature cooking, defrost, plate warming, keep warm, Hotair gentle
- Temperature range 30 °C - 275 °C
- Cavity volume: 71 litre capacity

### Level independent telescopic rails

- 5 shelf positions
- Available as an additional accessory

### Design

- Rotary dial, Retractable control dials, round
- Extra large capacity oven with grey enamel

### Cleaning

- EcoClean Direct : back panel
- Cleaning Assistance: hydrolyse manual
- Full glass inner door

### Programmes/functions

- BE54
- Electronic clock timer
- Digital temperature display with proposal  
Actual temperature display Heating-up indicator AutoPilot  
Automatic start
- AutoPilot, 40
- Drop down door, SoftClose, SoftOpen
- Straight bar handle
- Automatic programmes
- Fast pre-heating function
- Interior halogen light, Light on/off when oven door opened/  
closed
- Integral cooling fan
- Info button
- Home Connect ready

### Accessories

- 2 x combination grid, 1 x universal pan

### Features

- Maximum window temperature 40° C
- Control panel lock  
Automatic safety switch off Residual heat indicator Door  
contact switch

### Technical information

- 120 cm Cable length
- Nominal voltage: 220 - 240 V
- Total connected load electric: 2.99 KW
- Energy efficiency rating (acc. EU Nr. 65/2014): A  
Energy consumption per cycle in conventional mode: 0.97 kWh  
Energy consumption per cycle in fan-forced convection  
mode: 0.81 kWh  
Number of cavities: Main cavity Heat source: electrical Cavity  
volume: 71 litre capacity

### Performance/technical information

- Appliance dimension (h x w x d): 595 mm x 594 mm x 548 mm
- Niche dimension (h x w x d): 585 mm - 595 mm x 560 mm - 568  
mm x 550 mm
- Please refer to the dimensions provided in the installation  
manual
- We recommend you to choose complementary products  
within SER6, in order to assure an optimal design combination  
of your Built-In appliances.

**Serie | 6, Built-in oven, 60 x 60 cm, Black  
HBG539BB6B**

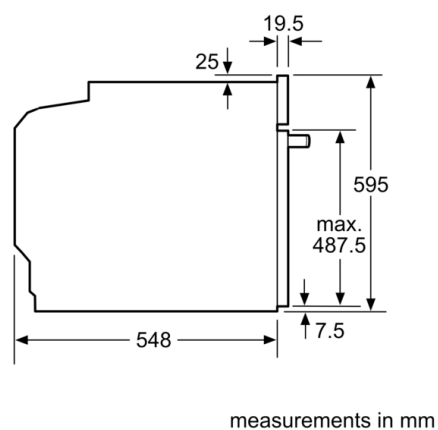
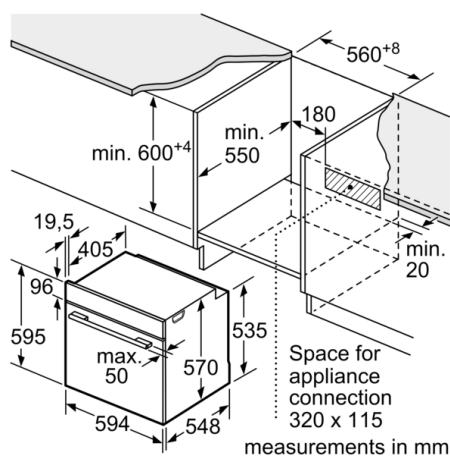

Installation with a hob.

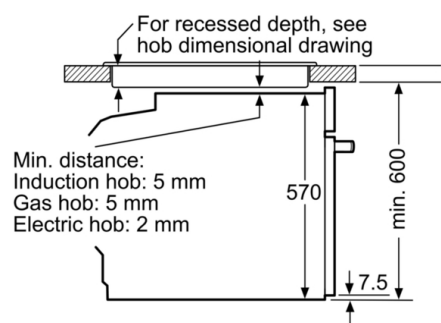

measurements in mm

Measurements in mm

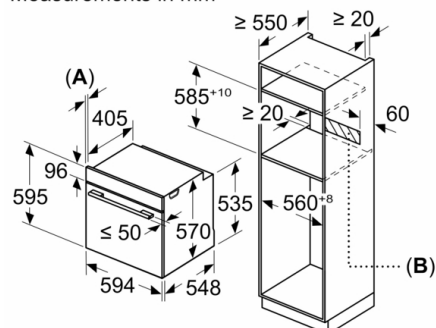

**A:** 19.5 mm  
**B:** Space for appliance connection 320 x 115 mm