

Serie | 8 Steamer

Compact steamer CDG634BS1B brushed steel



The steamer: prepare foods especially gently, retaining the aroma and vitamins.

- **Steam function:** for gentle, healthy food preparation.
- **AutoPilot 17:** every dish is a perfect success thanks to 17 pre-set automatic programmes.
- **TFT display control:** easy-to-use thanks to the control ring with full text and symbols.
- **Flap door with SoftOpen and SoftClose:** the oven door opens and closes especially gently and quietly.

Technical Data

Color / Material Front :	Stainless steel
Construction type :	Built-in
Required niche size for installation (HxWxD) :	450 x 560 x 550
Dimensions of the product (mm) :	455 x 594 x 548
Control Panel Material :	Stainless steel
Door Material :	Glass
Net weight (kg) :	25.0
Approval certificates :	CE, VDE
Length of electrical supply cord (cm) :	150
EAN code :	4242002810317
Current (A) :	10
Voltage (V) :	220-240
Frequency (Hz) :	60; 50
Plug type :	GB plug
Approval certificates :	CE, VDE

Included accessories

1 x steam container, punched, size L, 1 x steam container, unpunched, size L, 1 x sponge



Optional accessories

HEZ6SCC0 : Cookbook

Serie | 8 Steamer

Compact steamer

CDG634BS1B

brushed steel

The steamer: prepare foods especially gently, retaining the aroma and vitamins.

Key features

- 2.5"-TFT colour and text display with direct select buttons
- Supporting systems: Auto cook programmes
- Digital temperature display with proposal
Actual temperature display
Heating-up indicator
automatic programmes

Design

- Stainless steel control wheel
- Drop down door, SoftClose, SoftOpen
- Straight bar handle with steel handle fixing blocks

Features

- Electronic clock timer
- Interior light
- Cavity inner surface: Stainless steel
- Pyrolitic proof trayholder and baking tray
- Integral cooling fan
- Stainless-steel fan
- 3 shelf positions
- Full glass inner door
- Control panel lock
Automatic safety switch off
Start button
Door contact switch
- Tank empty indicator

Programmes/functions

- Additional heating methods with steam: Steam cooking , reheating, Dough proving, defrost
- Additional functions:
Descaling programme
autom. boiling point detection

Performance/technical information

- Cavity volume: 38 litres
- Water tank 1.3 litre
- Smooth steel oven interior
- Temperature range 30 °C - 100 °C
- Length of mains cable: 150 cm
- Total connected load electric: 1.75 KW
- Appliance dimension (hxwxh): 455 mm x 594 mm x 548 mm
- Niche dimension (hxwxh): 450 mm - 455 mm x 560 mm - 568 mm x 550 mm
- Maximum window temperature 40° C
- Please reference the built-in dimensions provided in the installation drawing
- Energy efficiency rating (acc. EU Nr. 65/2014):
Number of cavities: 1
Heat source: electrical
Cavity volume: 38 litres

Standard accessories

- 1 x steam container, punched, size L, 1 x steam container, unpunched, size L, 1 x sponge

Serie | 8 Steamer

Compact steamer CDG634BS1B brushed steel

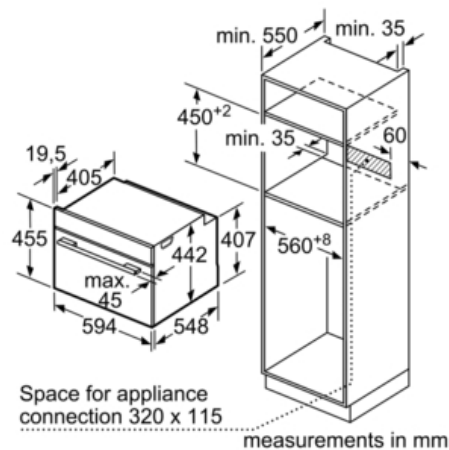
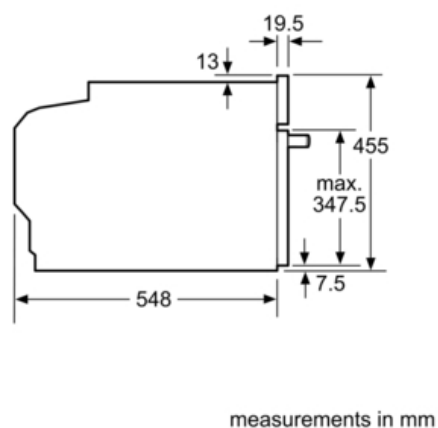
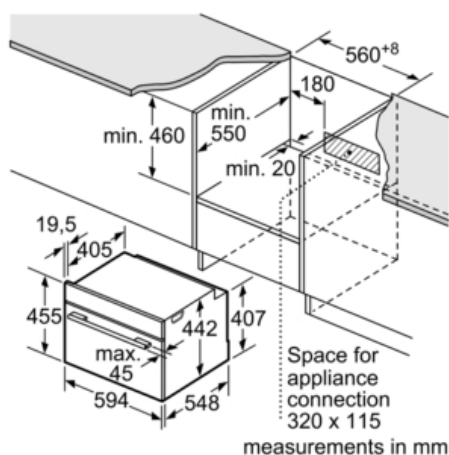

Installation with a hob.

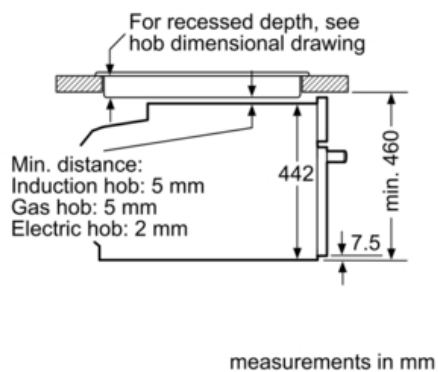

If the compact appliance will be installed underneath a hob, the following worktop thicknesses (including substructure if necessary) must be taken into account.

Hob type	min. worktop thickness	
	fitted	flush
Induction hob	42 mm	43 mm
Full surface induction hob	52 mm	53 mm
Gas hob	32 mm	39 mm
Electric hob	32 mm	35 mm