

Serie | 8 Microwave oven

Compact oven with microwave
and Added Steam
CNG6764S6B
brushed steel



The compact steam oven with PerfectBake, PerfectRoast, microwave and added steam: for perfect crispy results, even when time is short.

- **PerfectBake Sensor and PerfectRoast thermometer:** the easy way to perfect baking and roasting results.
- **Microwave- with steam function:** for fast and perfect reheating.
- **BoschAssist:** automatic setting of the optimal type of heat, temperature and time for countless dishes.
- **TFT touchscreen control:** easy-to-use thanks to the control ring with full text and images.
- **Home Connect:** home appliances with smart connectivity for an easier everyday life.

Technical Data

Type of micro-wave oven :	MW-Combi
Type of control :	Electronic
Color / Material Front :	Stainless steel
Dimensions of the product (mm) :	455 x 594 x 548
Cavity dimensions (mm) :	237.0 x 480 x 392.0
Length of electrical supply cord (cm) :	150
Net weight (kg) :	41.0
Gross weight (kg) :	44.0
EAN code :	4242002952468
Maximum micro-wave power (W) :	900
Connection rating (W) :	3600
Current (A) :	16
Voltage (V) :	220-240
Frequency (Hz) :	50; 60
Plug type :	no plug

Included accessories

2 x combination grid
1 x universal pan



4 242002 952468

Optional accessories

HEZ6RCC0 : Cookbook

Serie | 8 Microwave oven

Compact oven with microwave and Added Steam

CNG6764S6B
brushed steel

The compact steam oven with PerfectBake, PerfectRoast, microwave and added steam: for perfect crispy results, even when time is short.

Key Information

- 3x 2,5"-TFT colour and graphics display with direct touch function
- Pyrolytic self-cleaning function
- BoschAssist
- PerfectBake sensor
PerfectRoast meatprobe
- Digital temperature display with proposal
Actual temperature display
Heating-up indicator
Sabbath setting

Design

- Stainless steel control wheel
- Drop down door, SoftClose, SoftOpen
- Straight bar handle

Features

- Electronic clock timer
- Info button
- LED light
- Cavity inner surface: Enamel anthracite
- Pyrolytic proof trayholder and baking tray
- Integral cooling fan
- 3 shelf positions
- Microwave top door
- Door lock during pyrolytic cleaning
Control panel lock
Automatic safety switch off
Residual heat indicator
Start button
Door contact switch
- Tank empty indicator

Programmes/functions

- Compact oven with microwave with 14 heating methods:
4D Hotair, Hotair Eco, conventional top and bottom heat, conventional heat Eco, Hotair grilling, full width variable grill, half width grill, pizza function, bottom heat, intensive heat,

low temperature cooking, plate warming, dehydrate, keep warm

- Additional heating methods with microwave: Microwave, Combi microwave variable
- Additional heating methods with steam: reheating, Dough proving
- Additional functions:
Descaling programme
Drying function
- Fast heat

Performance/technical information

- Cavity volume: 45 litre capacity
- Water tank 1 litre
- Location of the steam generator is outside of the cavity
- Temperature range 30 °C - 300 °C
- Microwave inverter technology
- Stirrer fan distribution
- Max. Power: 900 W; 5 Microwave power settings (90 W, 180 W, 360 W, 600 W, 900 W) with Inverter (MW)
- Length of mains cable: 150 cm
- Total connected load electric: 3.6 KW
- Appliance dimension (h x w x d): 455 mm x 594 mm x 548 mm
- Niche dimension (h x w x d): 450 mm - 455 mm x 560 mm - 568 mm x 550 mm
- Maximum window temperature 30° C
- Please reference the built-in dimensions provided in the installation drawing
- Energy efficiency rating (acc. EU Nr. 65/2014):
Energy consumption per cycle in conventional mode:
NO_FEATURE
Energy consumption per cycle in fan-forced convection mode:
NO_FEATURE
Number of cavities: 1
Heat source: electrical
Cavity volume: 45 litre capacity

Standard accessories

- Pull out system: 1 level telescopic shelf, standard extension
- 2 x combination grid, 1 x universal pan

Serie | 8 Microwave oven

Compact oven with microwave and Added Steam

CNG6764S6B
brushed steel

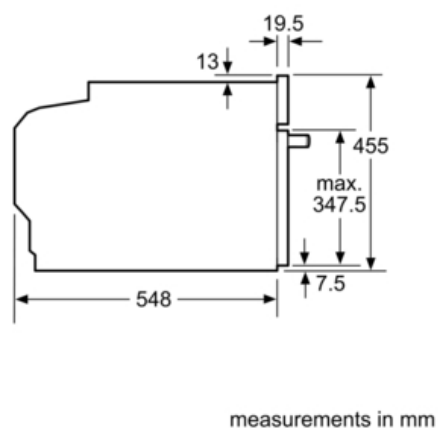
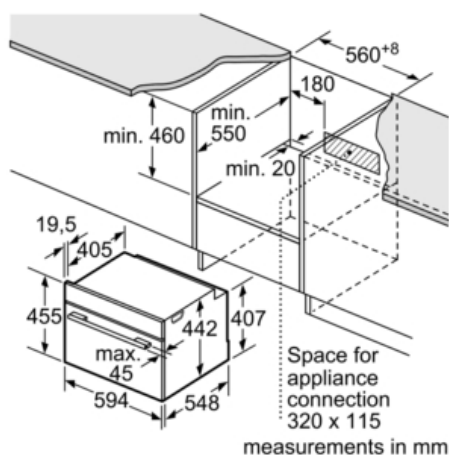

Installation with a hob.

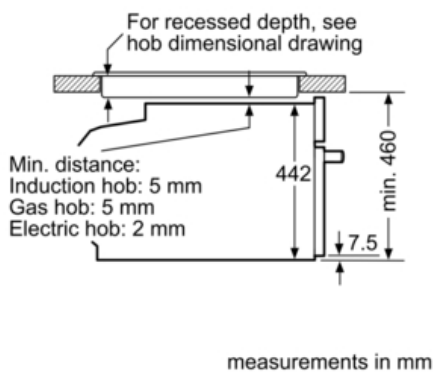

If the compact appliance will be installed underneath a hob, the following worktop thicknesses (including substructure if necessary) must be taken into account.

Hob type	min. worktop thickness	
	fitted	flush
Induction hob	42 mm	43 mm
Full surface induction hob	52 mm	53 mm
Gas hob	32 mm	39 mm
Electric hob	32 mm	35 mm

